

The compact form factor combined with optimised cooling performance of Sony's CMOS IMX428, 7.1MP sensor makes this camera ideal for scientific imaging. Due to the premium design of the ACIS 7.1 from our in-house R&D team, the camera features low read out noise electronics and high quantum efficiency, and will provide reliable imaging performance ideally suited to applications where a wide field of view is required as a result of low light conditions. The anodised case is specifically designed for maximum EMC performance in an imaging system environment.

The ACIS 7.1 comes complete with a comprehensive software development kit and is also fully compatible with many third party image acquisition programs.

The base level ACIS 7.1 can be customised to suit the requirements of specific OEM applications so please contact us using the details below if you would like any modifications.

Key Features

- USB3 connection
- Sony IMX 428 CMOS sensor
- Manufactured at our ISO 9001 certified European premises
- The 7.1mp sensor is housed in a dried, air-tight environment
- Three different modes available
- Available as a board set camera
- BK7 optical window with BBAR coatings on both sides

Software Development Kit (SDK)

- C++ Library covering all camera functions
- Visual Basic wrapper
- .net Wrapper
- Linux Driver

Atik OEM ACIS 7.1 M Pixel

Sensor Mono	Sony IMX428 LLJ-C
Sensor Colour	Sony IMX428 LQJ-C
Sensor Diagonal	17.6 mm
Sensor Format	CMOS 1.1"
Resolution H	3208 x pixels
Resolution V	2208 x pixels
Pixel L & W	4.5 µm
Noise	5e- (Typical)
ADC	16 bit
Cooling	T(amb)-35°C (Regulated)
Dark Current	0.03e-/p /s at -10°C
Back Focus	12.5 mm ±0.5
Weight	Approximately 530g
Interface	USB 3.0
Power	12VDC 0.8A (Centre positive)

Key Benefits

- High speed communication with other devices
- CCD rivalling sensitivity, CMOS price
- Reliable and robust
- Condensation free imaging
- Enhanced versatility due to mode switching
- Customisable to your specific requirements
- Reflection free imaging

Available Accessories

- Universal Power Supply (90-240VAC)/DC 12V
- C-Mount lens adaptor

Ordering Codes

Atik OEM ACIS 7.1-C	colour
Atik OEM ACIS 7.1-M	mono

Service Item

- Desiccant Cartridge



OEM ACIS 7.1

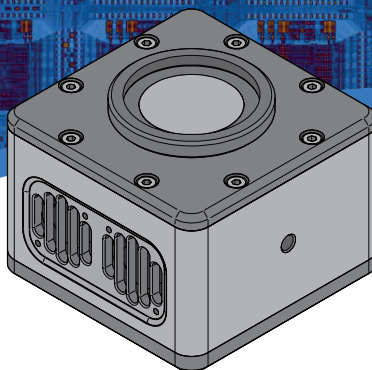

ACIS Mechanical Drawing

ALL DIMENSIONS IN mm

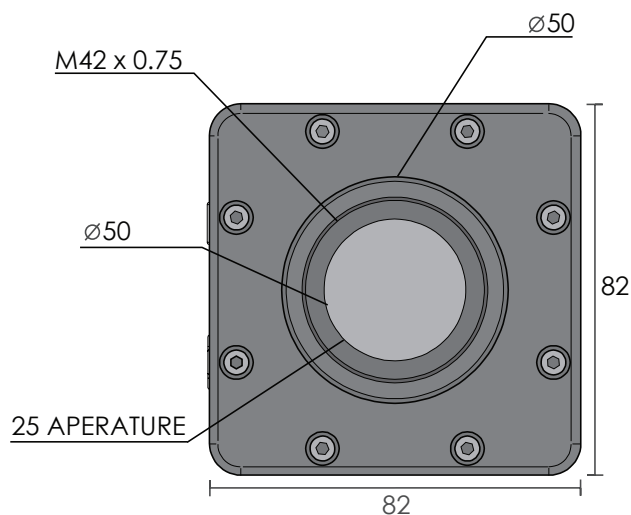
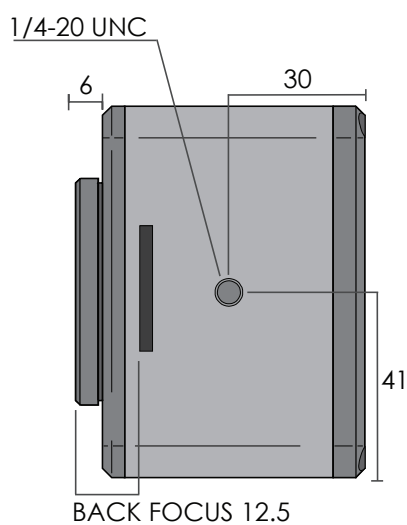
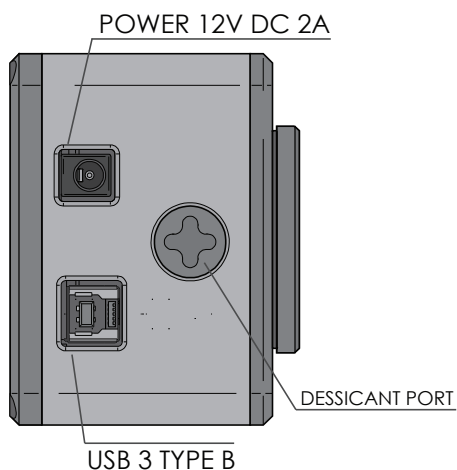
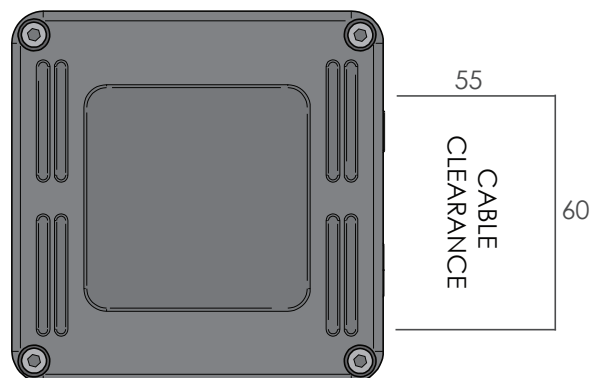
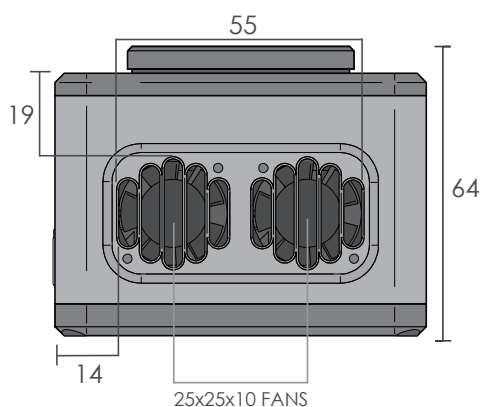

For enquiries, please contact:

Atik cameras
Unit 8 Lodge Farm Barns, New Road, Bawburgh
Norwich, NR9 3LZ, United Kingdom

T: +44 (0)1603 740397
F: +44 (0)1603 340600
E: sales@atik-cameras.com
W: www.atik-cameras.com