

The compact form factor combined with optimised cooling performance makes the ACIS series ideal for scientific imaging. Due to the premium design from our in-house R&D team, these cameras feature low read out noise electronics and high quantum efficiency, and will provide reliable imaging performance ideally suited to applications where a wide field of view is required as a result of low light conditions. The anodised case is specifically designed for maximum EMC performance in an imaging system environment.

The ACIS series comes complete with a comprehensive software development kit and is also fully compatible with many third party image acquisition programs.

The base level cameras can be customised to suit the requirements of specific OEM applications so please contact us if you would like any modifications.

Software Development Kit (SDK)

- C++ Library covering all camera functions
- Visual Basic wrapper
- .net Wrapper
- Linux Driver

Available Accessories

- Universal Power Supply (90-240VAC)/DC 12V
- C-Mount lens adaptor

Ordering Codes

Atik OEM ACIS 2.4-C	colour
Atik OEM ACIS 2.4-M	mono
Atik OEM ACIS 7.1-C	colour
Atik OEM ACIS 7.1-M	mono
Atik OEM ACIS 12.3-C	colour
Atik OEM ACIS 12.3-M	mono

Service Item

- Desiccant Cartridge

Key Features

- USB3 connection
- A choice Sony CMOS sensors
- Manufactured at our ISO 9001 certified European premises
- The sensors are housed in a dried, air-tight environment
- Three different modes available
- Available as a board set camera
- BK7 optical window with BBAR coatings on both sides

Key Benefits

- High speed communication with other devices
- CCD rivalling sensitivity, CMOS price
- Reliable and robust
- Condensation free imaging
- Enhanced versatility due to mode switching
- Customisable to your specific requirements
- Reflection free imaging



Atik Cameras

Unit 8 Lodge Farm Barns, New Road, Bawburgh
Norwich, NR9 3LZ, United Kingdom

T: +44 (0)1603 740397

F: +44 (0)1603 340600

E: sales@atik-cameras.com

W: www.atik-cameras.com



ACIS SERIES			
	ACIS 2.4	ACIS 7.1	ACIS 12.3
Sensor	Sony IMX249 CMOS	Sony IMX428 CMOS	Sony IMX304 CMOS
Resolution H	1920 x pixels	3208 x pixels	4096 x pixels
Resolution V	1200 x pixels	2208 x pixels	3000 x pixels
Pixel size	5.86 μm	4.5 μm	3.45 μm
Readout Noise	3e- (Typical) at low gain	3e- (Typical) at low gain	3e- (Typical) at low gain
ADC	12 bit	12 bit	12 bit
Cooling	T(amb)-35°C (Regulated)	T(amb)-35°C (Regulated)	T(amb)-35°C (Regulated)
Back Focus	12.5 mm ± 0.5	12.5 mm ± 0.5	12.5 mm ± 0.5
Max exposure	Unlimited	Unlimited	Unlimited
Min exposure	0.001s	0.001s	0.001s
Gain factor	Variable	Variable	Variable
Full well capacity	~33,000e-	~20,000e-	~11,000e-
Thread on front	M42 x 0.75	M42 x 0.75	M42 x 0.75
Weight	Approximately 530g	Approximately 530g	Approximately 530g
Interface	USB 3.0	USB 3.0	USB 3.0
Power	12VDC 2A (Centre positive)	12VDC 2A (Centre positive)	12VDC 2A (Centre positive)
Mono or colour	Either	Either	Either
Shutter type	Global shutter	Global shutter	Global shutter

For any information not listed, please contact our dedicated sales team.



Atik Cameras

Unit 8 Lodge Farm Barns, New Road, Bawburgh
Norwich, NR9 3LZ, United Kingdom

T: +44 (0)1603 740397

F: +44 (0)1603 340600

E: sales@atik-cameras.com

W: www.atik-cameras.com



ACIS SERIES

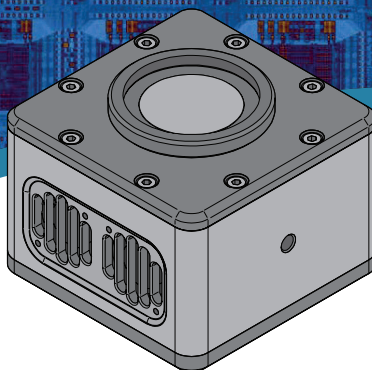

ACIS Mechanical Drawing

ALL DIMENSIONS IN mm

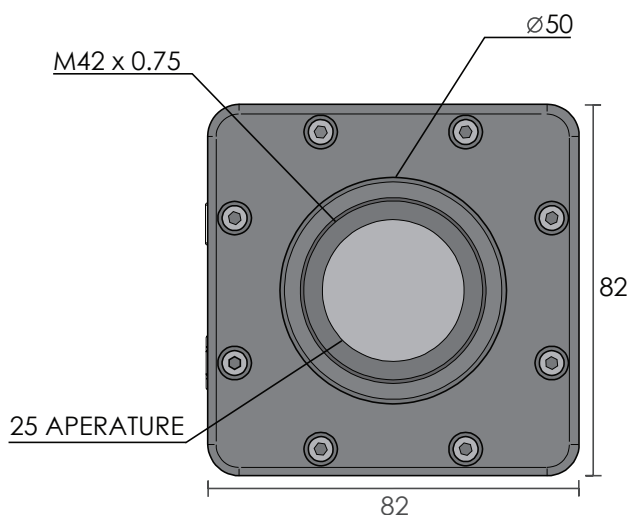
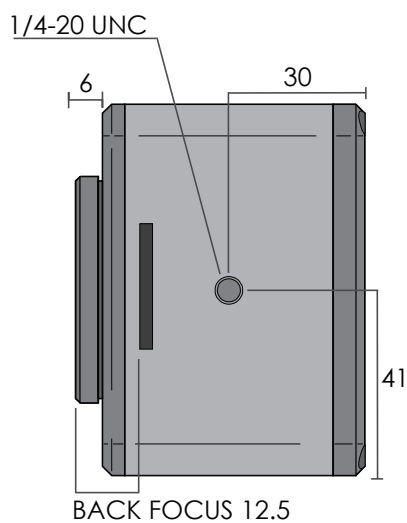
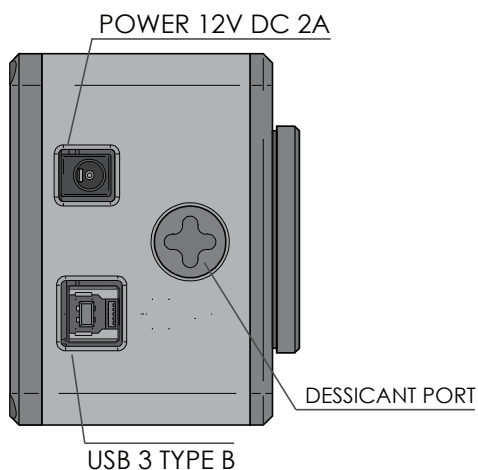
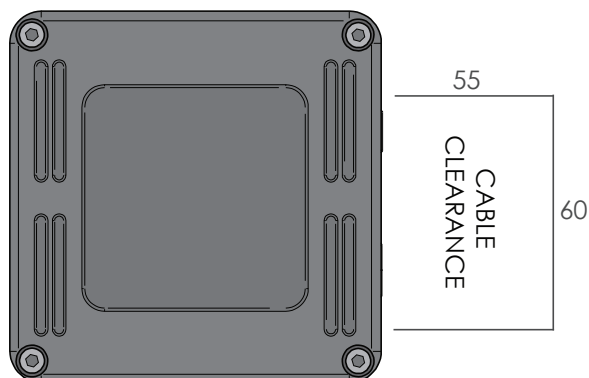
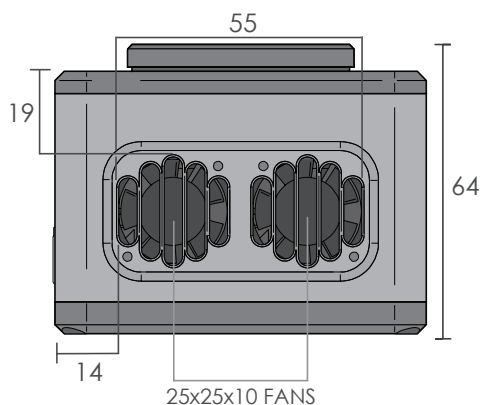

Atik Cameras

Unit 8 Lodge Farm Barns, New Road, Bawburgh
Norwich, NR9 3LZ, United Kingdom

T: +44 (0)1603 740397

F: +44 (0)1603 340600

E: sales@atik-cameras.com

W: www.atik-cameras.com